

蒂德全球销售服务网络
DEED GLOBAL SALES & SERVICE NETWORK



- 中国总部
China Headquarter
- 德国总部
Germany Headquarter
- 全球代理商
Global sales centers
- 售后服务网点
After-sales service centers



中国销售中心
China Sales Center

销售热线 / Sales Hotline(China): 0537-3775666
外贸热线 / Sales Hotline(overseas): +86 537 3451030
售后热线 / After-sales Service: 400-113-6699
企业邮箱 / E-mail: sale@deedmt.com / itd@deedmt.com
企业网址 / Website: www.deedmt.com (中国/China) / www.cncindeed.com(国际/overseas)
地址: 山东省济宁市兖州经济开发区永安路
Address: Yong'an Road,Industrial Park,Yanzhou District,Jining City,Shandong Province.



德国 (Germany)
欧洲研发、销售中心
Europe R&D, Sales Center
地址 / Address: Stahlwerkstraße 32-D-57555 Mundersbach



HTC卧式车削中心

HTC Horizontal Turning Center

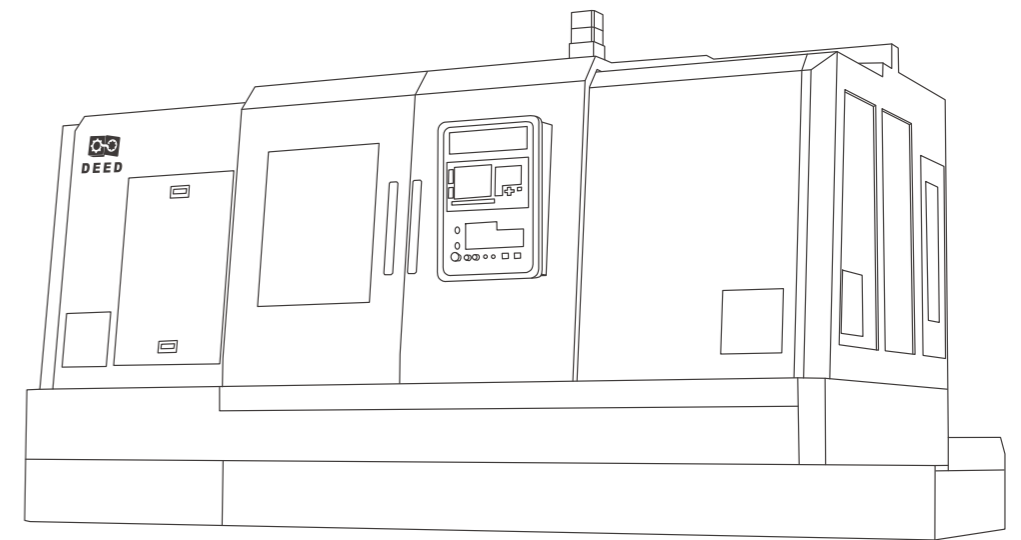

精 | Precise



大 | Large



特 | Customized

山东蒂德精密机床有限公司

SHANDONG DEED PRECISION MACHINE TOOL CO.,LTD.

蒂德简介

COMPANY PROFILE

山东蒂德精密机床有限公司是一家集高档数控机床研发、生产、销售为一体的高端装备企业，位于济宁市兖州区。公司以高速立式加工中心、大型龙门加工中心、高效钻攻加工中心、高精度车削加工中心、高精度五轴联动加工中心、卧式铣镗加工中心及卧式加工中心为主导产品，广泛服务于国内外航空、航天、军工、船舶、汽车、工程机械、轨道交通、5G、精密模具等重点领域。公司大力实施“走出去，引进来”的发展战略，与德国知名数控机床制造企业ROTTLER达成全面战略合作，联合开发具有世界领先水平的高档精密机床，共同开拓全球高端市场，并在德国设立了高端机床研发中心及制造基地——“Hipreed Technology GmbH（汉普瑞德科技有限公司）”，全面实施国际化运营，实现了德国技术和中国制造的完美结合。公司建有国内外5大研发中心，拥有6大省市级创新平台，具备高档机床研发、新材料研制、先进技术测试和可靠性提升等全面的研发、实验、测试、制造优势。通过持续创新和不断突破，已承担25项重点政府科技项目，获得各类知识产权200余项，科技成果奖15项，整体开发、创新能力行业领先。凭借强大的技术、创新优势，公司分别通过了ISO9001质量管理体系认证、ISO14001环境管理体系认证和ISO45001职业健康安全管理体系认证，荣获“国家高新技术企业”、“国家专精特新‘小巨人’企业”、中国机床行业最高奖“春燕奖”、“中国机床工具行业‘产品质量十佳’”、“中国机械工业科技进步二等奖”等80多项重点荣誉。

Shandong Deed Precision Machine Tool Co., Ltd. is a high-end equipment enterprise integrating R&D, production and sales of high-end CNC machine tools, located in Yanzhou District, Jining City. The company takes high-speed vertical machining center, large scale gantry machining center, high-efficiency drilling & tapping machining center, high-precision turning center, high-precision five-axis linkage machining center, horizontal milling & boring machining center and horizontal machining center as the leading products, and serves a wide range of key industries such as aviation, aerospace, military, shipbuilding, automobile, construction machinery, rail transit, 5G, precision mold and others, both in the domestic and overseas markets. The company vigorously implements the development strategy of "going out and bringing in", and has reached a comprehensive strategic cooperation with the well-known German CNC machine tool manufacturing enterprise ROTTLER to jointly develop high-grade precision machine tools of the world's leading level and jointly explore the global high-end market. Establishing a high-end machine tool R & D center and manufacturing base in Germany - "Hipreed Technology GmbH", fully implementing international operations and achieving the perfect combination of German technology and Chinese manufacturing. The company has five domestic and foreign R & D centers, with six provincial and municipal innovation platforms, with comprehensive R & D, experiment, testing, manufacturing advantages of high-grade machine tool research and development, new material development, advanced technology testing and reliability improvement. Through continuous innovation and breakthrough, it has undertaken 25 key government science and technology projects, obtained more than 200 intellectual property rights of various types, 15 scientific and technological achievement awards, and is in a leading position of the overall development and innovation ability in the industry. With strong technology and innovation advantages, the company has passed the ISO9001 quality management system certification, ISO14001 environmental management system certification and ISO45001 occupational health and safety management system certification. It has won more than 80 key awards such as the "National High-Tech Enterprise", "National Specialized New Little Giant Enterprise", the highest award of China's machine tool industry the "Spring Swallow Award", "Top 10 Product Quality of China's Machine Tool Industry", and "Chinese Machinery Industry Science & Technology Progress 2nd Award" etc.

CONTENTS

04

产品简介 PRODUCT INTRODUCTION

产品介绍、产品加工范围、产品优势
PRODUCT INTRODUCTION,PRODUCT PROCESSING RANGE,PRODUCT ADVANTAGES

06

加工案例 PROCESSING CASES

加工能力展示、应用案例
PROCESSING PERFORMANCE, APPLICATION CASES

07

技术参数 TECHNICAL PARAMETERS

主轴功率扭矩、产品参数、标配介绍
POWER&TORQUE DIAGRAM,TECHNICAL PARAMETERS,STANDARD CONFIGURATIONS

09

售后服务 AFTER-SALES SERVICE

24/7 全天候不间断服务
24/7 NON-STOP SERVICE



03/04



HTC系列 卧式车削中心

HTC-Series Horizontal Turning Center

本系列卧式车床采用30°斜床身，由蒂德根据多年专业经验与最新技术设计制造。采用先进的矿物铸件整体式床身，为机床表面加工质量、精度保持性提供了良好的基础。

本系列机床为针对盘套类零件的数控车削加工中心，适合加工内外圆柱面、圆锥面、阶梯面、沟槽、球面及其他各种回转曲面、各种公制、英制内外螺纹，可在加装特殊功能部件的情况下，可一次装夹实现车削、磨削、铣削、钻孔、攻牙、滚齿、插槽等功能，广泛用于轴承、汽车、齿轮等行业。

This series of horizontal lathes adopt 30°slant bed, and is designed and manufactured by Deed based on many years of professional experience and latest technology. The use of advanced mineral castings integral bed provides a good foundation for the quality and accuracy of the surface processing of the machine tool.

This series of machine tools is a CNC turning center for disc sleeve parts, suitable for machining internal and external cylindrical, conical, stepped, groove, spherical and other rotary surfaces, a variety of metric and inch internal and external threads, can be installed in the case of special functional parts, can be once clamped to achieve turning, grinding, milling, drilling, tapping, hobbing, slotting and other functions. Widely used in bearing, automobile, gear and other industries.

产品简介

PRODUCT INTRODUCTION

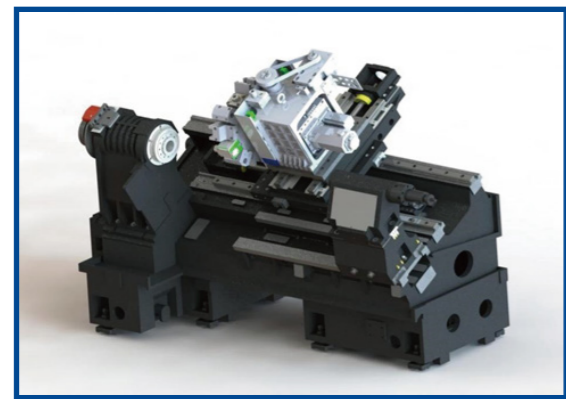

床身采用矿物材料铸造，该材料具有良好的吸振性、热稳定性，使得机床表面加工质量得到提升，精度保持性表现更优秀。

The bed is cast with mineral material, which has good vibration absorption and thermal stability, so that the surface processing quality of the machine tool is improved and the accuracy retention performance is better.



高刚性主轴采用高刚性圆柱滚子轴承，保证高转速情况下能获得高刚性切削。

High rigidity spindle adopts high rigidity cylindrical roller bearing to ensure high rigidity cutting at high rotation speed.



标准配置高刚性结构尾座，增加工件加工刚性，减少振刀带来的加工影响，提升机床加工表面质量与加工精度。

Standard configuration of high rigid structure tailstock, increase workpiece processing rigidity, reduce machining impact brought by vibrating tool, improve machining surface quality and machining accuracy.

加工案例

PROCESSING CASES

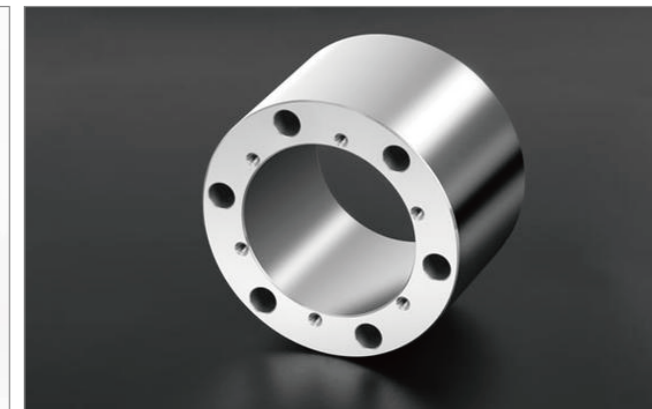
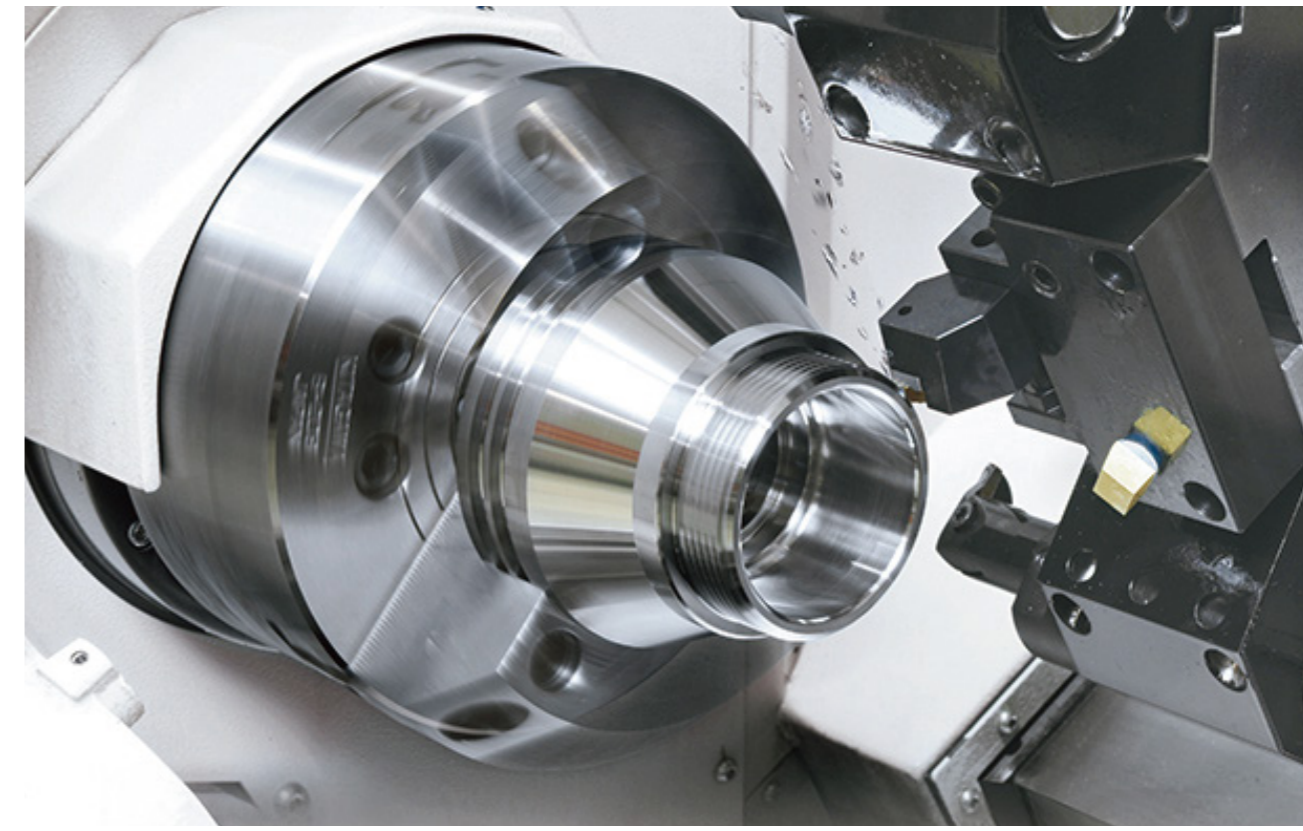

技术参数

TECHNICAL PARAMETER

配置 Configuration		型号 Model	单位 Unit	HTC420	HTC560	HTC600	HTC700	HTC1000
系统 System	数控系统 CNC system	-	-	Fanuc Oi-TF (type 5)	Fanuc Oi-TF (type 5)	Fanuc Oi-TF (type 5)	Fanuc Oi-TF (type 1)	Fanuc Oi-TF (type 1)
加工范围 Processing range	床身最大回转直径 Max swing dia. over bed	mm		Φ420	Φ560	Φ600	Φ700	Φ1000
	最大加工直径 Max. Processing dia.	mm		Φ380	Φ480	Φ540	Φ630	Φ900
	最大加工长度 Max. processing length	mm		500	520/750/1000	1020/1520	690/970/1590 /2190/3190	3000/6000
主轴 Spindle	卡盘尺寸 Chuck dia.	英寸 inch		8	8	10	12	18
	主轴鼻端 Spindle nose	/		A2-6	A2-6	A2-8	A2-11	A2-15
	主轴功率 Spindle power	kw		11/15	11/15	15/18.5	22/30	37/45
尾座 Tailstock	尾座样式 Tailstock mode	/		手动液压 Manual hydraulic	手动液压 Manual hydraulic	手动液压 Manual hydraulic	手动液压 Manual hydraulic	可编程液压 Programmable hydraulic
	套筒锥度 Taper of sleeve	/		莫氏4# Morse	莫氏5# Morse	莫氏5# Morse	莫氏5# Morse	莫氏6# Morse
	套筒直径 Sleeve dia.	mm		65	80	100	100	160
	套筒行程 Sleeve travel	mm		80	80	150	125	150
刀塔 Turret	刀位数量 Tool Station Qty.	/		12	12	12	12	12
	方刀尺寸 Tool square size	mm		25*25	25*25	25*25	32*32	32*32
	镗刀直径 Boring tool dia.	mm		32	40	40	50	60

选配介绍

OPTIONS INTRODUCTION

高精度 HIGH ACCURACY



光栅尺
Linear scale

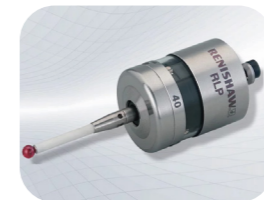

工件测量
Workpiece measurement

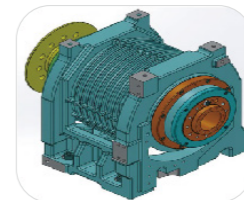

电主轴
Electric spindle

卡盘气密性检测
Chuck air tightness test
AICC
.....

自动化 AUTOMATIC

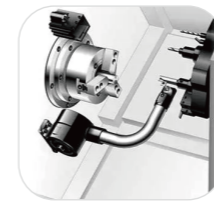

对刀仪
Tool setter



自动送料机
Automatic bar feeder



接料器
Parts catcher

自动门
Automatic door
卡盘清理吹水吹气
Chuck cleaning water blow air blow
可编程/伺服尾座
Programmable/Servo tailstock
刀具负载监测
Tool load monitoring
.....

人性化 HUMANIZED

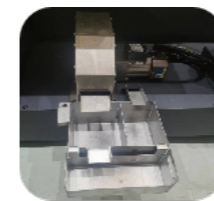

油水分离器
Oil water separator

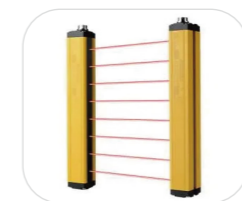

安全光幕
Safety light curtain



油雾收集器
Oil mist collector

工件计数器
Workpiece counter
刀具计数器
Tool counter
中心架
Center rest
.....

高性能 HIGH PERFORMANCE

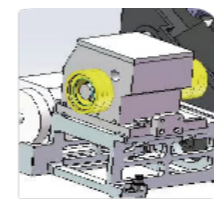

减速机
Reducer



增大卡盘
Enlarge chuck

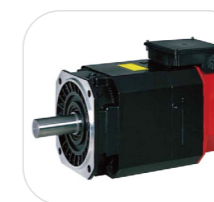

增大功率
Enlarge power

20/30BAR高压出水
High pressure water outlet
硬爪 Hard jaw
水枪 Water gun
.....

24/7 全天候不间断服务

24/7 NON-STOP SERVICE

- 售后服务工程师平均具有 10 年机床维修经验, 客户故障 2 小时响应回复;
After-sales engineers averagely have over 10 years machine tool industry service experience, can respond to customer failure within 2 hours;
- 全国设有 30 个销售及售后服务网点, 售后网点覆盖范围 24 小时内到场服务;
30 sales& service centers inside of China, can give on-site service within 24 hours in near covering range;
- 提供完善的客户培训计划及操作指南;
Comprehensive training system and operation guidance;
- 标准化的售后交机及售后服务流程;
Standardized machine delivery and after-sales service process;
- 购买机床, 终身服务。
1-time purchase, life-time service.



NOTES